

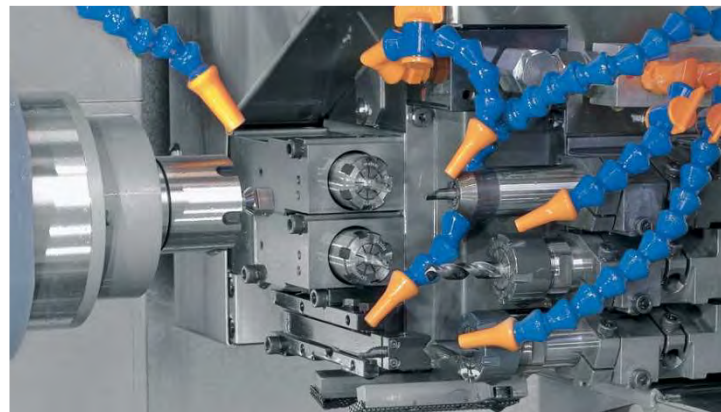

LinkB Group Co., Ltd.

Since 1960

Design, Manufacture, and Marketing for Precision Metal Parts.



www.linkbmetal.com

LinkB Group Co., Ltd.



Founded in 1960.

LinkB has focused on precision manufacturing for 60 years. We commit to provide precision products, diversified processes, flexible deployment, and high quality to all of our clients.

Our goal is to become the number one hardware manufacturer in the world.

We provide total solution which include designing, manufacturing, and marketing to achieve all customer needs.





Manufacturing Capabilities

- Diameter Range (OD Ø): Ø0.2~ Ø 700mm
- Max. Length*Width*Height:
2,000*1,000*700mm
- Accuracy Tolerance: ±0.002mm

Manufacturing Scale

- 4 Manufacturing sites

Worldwide Sales Office

- Tokyo
- San Jose
- Taiwan
- Hongkong
- Shanghai

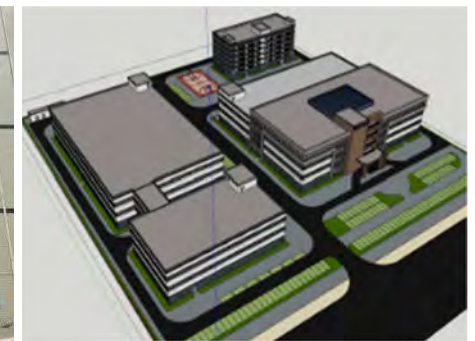

Worldwide Strategic Deployment

- Globalization: LinkB Group products are delivered to worldwide markets.
- Integrated global resources: manpower, R&D, and capital, etc
- Global markets: more than 10 countries
- Employee : 3,500+
- Manufacturing Space : 150,000 m²
- Annual Revenue : US\$ 380Million(Year2018)
- 4 R&D Center
- 4 Manufacturing base



Products & Process

● Professional of Precision Machining

- Manufacturing components/parts with high precision, diversified processes, and high quality whatever tiniest or largest range.

● Product

- Precision Nuts, Screws, Turn-milling Parts, Pins, CNC Parts, Die-casting Parts, Forging Parts, Stamping Parts, Surface treatment...

● Process Capability

- *Lathing, Turn-Milling, CNC, Die-casting, Forging, Stamping, Anodizing, Plating, Sandblasting, Etching, Carver, PVD, Polish, Grinding, Tool-making, etc.*



Machinable Raw Materials

● The Typical Material We Are Using (Include SAE / ASTM, JIS, DIN, etc.)

- Copper alloy: C63000, C39200, C95400, C3602, C3604, C36000, HPb59, HPb62, CZ131, CZ132, etc.
- Stainless steel: 301, 303, 304, 316, 316L(VIM/VAR), 410, 416, 420J2, 430(F), 440C, 17-4PH (630), etc.
- Alloy Steel: Wolfram steel, 4140, 4130, 1Cr13, 2Cr13, 3Cr13, GCr15, Q235, etc.
- Special alloy: WCu, Monel, Invar, Kovar, Inconel, 4J29/4J50, INVAR36, etc.
- Titanium alloy: TC4 ELI, Ti-2Al-2.5Zr, etc.
- Aluminum alloy: 2011, 2017, 5056, 5052, 6061, 6082, 6063, 7075, etc.
- Polymer material: PEEK, DELRIN, PTFE, ULTEM, TX-PET, POM, etc.
- Gold
- Silver.
- Others



Application & Services



- Analytical Instruments
- Oil & Gas
- Aerospace
- Medical Devices



- Datacom / Sensor
- Consumer Electronics
- Automobile
- Security



- New Energy
- Industrial / Vacuum Pump

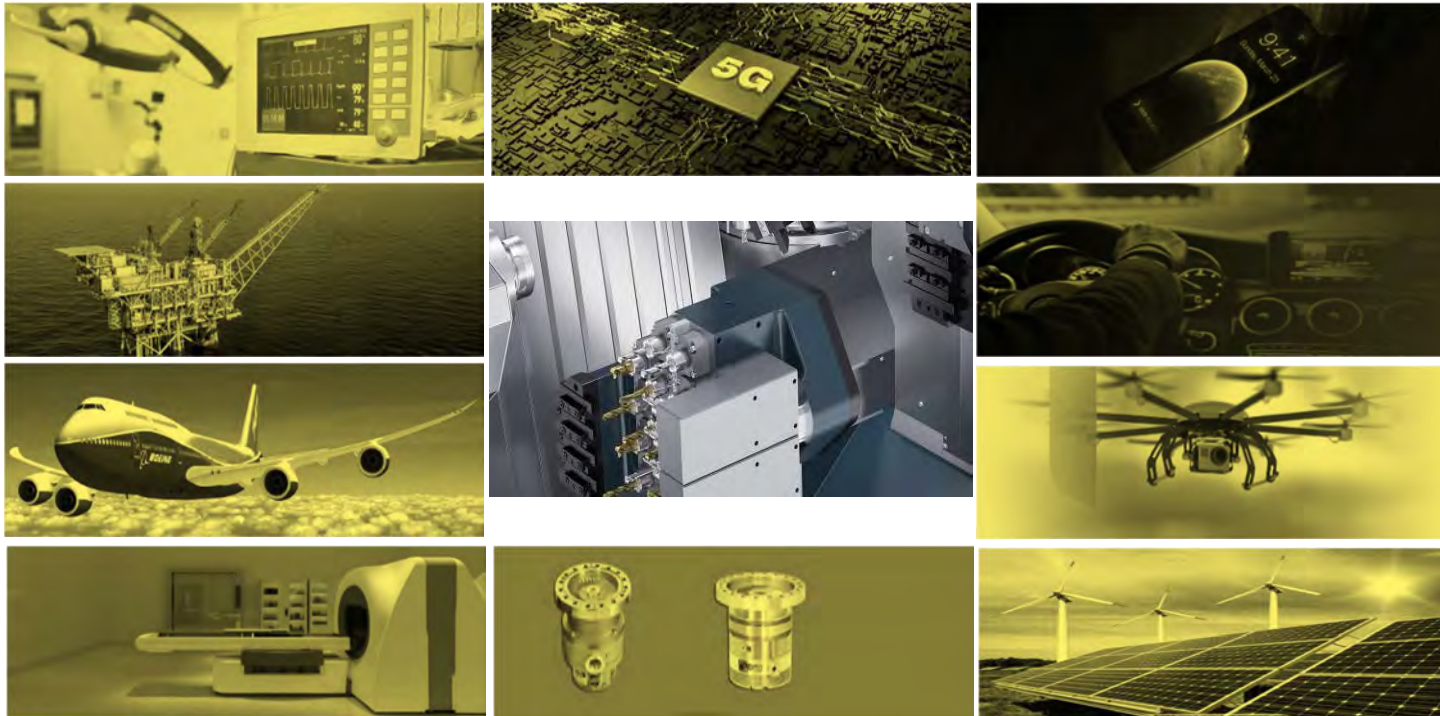

Turn-Milling Auto/Multi-Platform: Tiniest Size & Extremely Precise



Auto/Multi -platform:

Machine Brand	TORNOS
Machine Quantities	23 Sets
Max. bar capacity (Range)	~Ø50mm
Spindle rotation speed	~15,000rpm
Workpiece length with rotating guide bush	~300mm
Total number of tool positions	~40
Number of Axes	5~11
Accuracy	±0.002~0.005mm

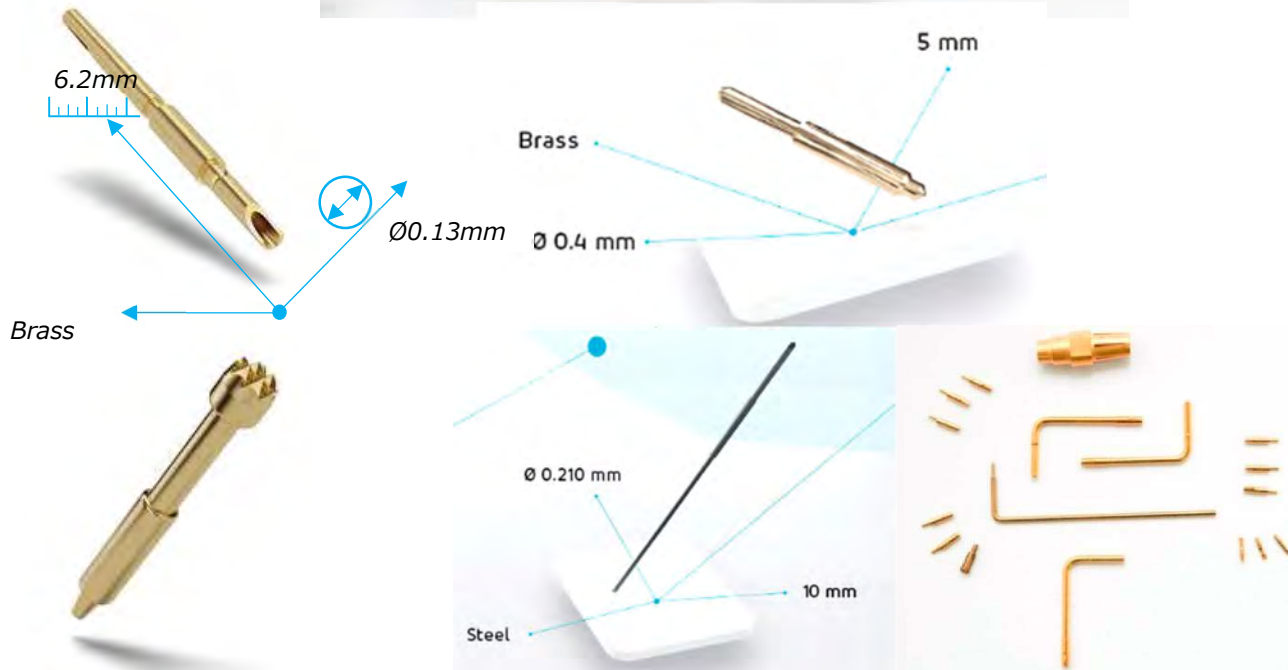

Application in:

- Industrial
- Datacom / Sensor
- Medical
- Aerospace
- Consumer Electronics
- Security
- Automobile
- New Energy

Product Type:

- Product Bodies, Components, RF Connectors, Socket, Power Contacts, Connectors, Outer Contacts, pin, RF, Coax Connectors, Fiber Optics, Sensors for diagnostic, Implants, Bone screws, Commissurotomies, Nut, Screw, etc.
- Others specify



Turn-Milling Auto/Multi-Platform: Normal Size & Highly Precise



Auto/Multi -platform:

Machine Brand	HYDROMAT
Machine Quantities	10 Sets
Max. Machining diameter (Range)	~Ø60mm
Spindle rotation speed	8,000~12,000rpm
Workpiece length with rotating guide bush	~170mm
Total number of working stages	~24
Number of Axes	4~5
Accuracy	±0.01~0.02mm

Application in:

- Industrial
- Datacom / Sensor
- Medical
- Aerospace
- Consumer Electronics
- Security
- Automobile
- New Energy

Product Type:

- Product Bodies, Components, Socket, Power Contacts, Connectors, Outer Contacts, pin, RF Connectors, Coax Connectors, Fiber Optics, Sensors for diagnostic, Implants, Bone screws, Commissurotomies, Nut, Screw, etc.
- Others specify

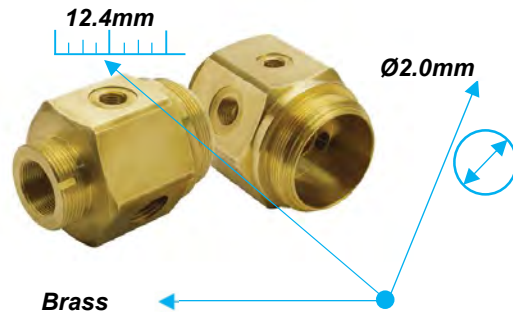

Turn-Milling: Small Size & Highly Precise



Multi -platform :

Machine Brand	TSUGAMI, STAR
Machine Quantities	60 Sets
Max. bar capacity (Range)	~Ø60mm
Spindle rotation speed	8,000~25,000rpm
Workpiece length with rotating guide bush	~220mm
Total number of tool positions	~14
Number of Axes	5, 6, 7
Accuracy	±0.005mm

Application in:

- Industrial
- Datacom / Sensor
- Medical
- Aerospace
- Consumer Electronics
- Security
- Automobile
- New Energy

Product Type:

- Product Bodies, Components, RF Connectors, Socket, Power Contacts, Connectors, Outer Contacts, pin, RF, Coax Connectors, Fiber Optics, Sensors for diagnostic, Implants, Bone screws, Commissurotomies, Nut, Screw, etc.
- Others specify



Stainless Steel

Turn-Milling: Normal Size & Highly Precise



Multi-platform:

Machine Brand	DOOSAN
Machine Quantities	60 Sets
Max. Machining diameter (Range)	~Ø450mm
Spindle rotation speed	8,000~20,000rpm
Workpiece length with rotating guide bush	~390mm
Total number of tool positions	~24
Number of Axes	4, 5, 6
Accuracy	±0.01~0.02mm

Application in:

- Industrial
- Datacom / Sensor
- Medical
- Aerospace
- Consumer Electronics
- Security
- Automobile
- New Energy

Product Type:

- Product Bodies, Components, Socket, Power Contacts, Connectors, Outer Contacts, pin, RF Connectors, Coax Connectors, Fiber Optics, Sensors for diagnostic, Implants, Bone screws, Commissurotomies, Nut, Screw, etc.
- Other specify

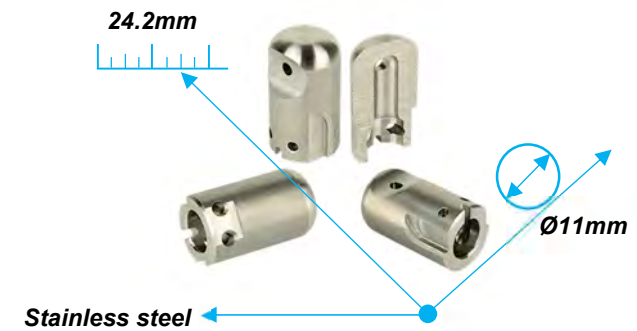
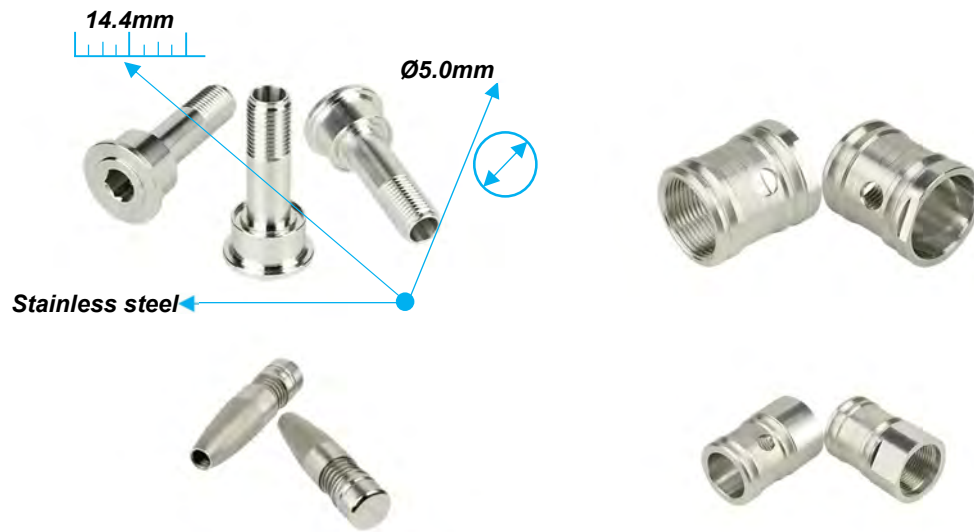

Milling: Large Size & Precise Part



Horizontal Center/Vertical:

Machine Brand	DOOSAN, OKUMA, QUASER, TAIKAN
Machine Quantities	58 Sets
Max. Machining diameter (Range)	~Ø700mm
Spindle rotation speed	8,000~12,000rpm
Workpiece length with rotating guide bush	~2,000mm
Total number of tool positions	~14
Number of Axes	~5
Accuracy	±0.01~0.02mm

Application in:

- Oil & Gas
- Vacuum Pump
- Industry
- Aerospace
- New Energy
- Automobile

Product Type:

- Product Bodies, Components, Socket, Power Contacts, Connectors, Outer Contacts, pin, Nut, Screw, etc.



Lathe & Machining Center



CNC Lathe & Machining center:

Machine Brand	MAZARK, GOOGWAY, HAAS, MIYANO
Machine Quantities	154 Sets
Max. Machining diameter (Range)	~Ø700mm
Spindle rotation speed	8,000~12,000rpm
Workpiece length with rotating guide bush	~2,000mm
Total number of tool positions	~14
Number of Axes	~5
Accuracy	±0.01~0.02mm

Application in:

- Oil & Gas
- Vacuum Pump
- Industry
- Aerospace
- New Energy
- Automobile

Product Type:

- Product Bodies, Components, Socket, Power Contacts, Connectors, Outer Contacts, Pin, Nut, Screw, etc.
- Others specify

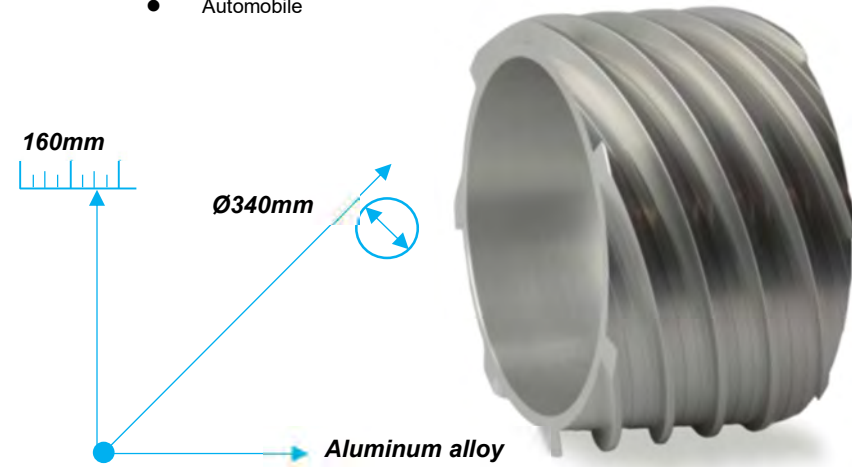
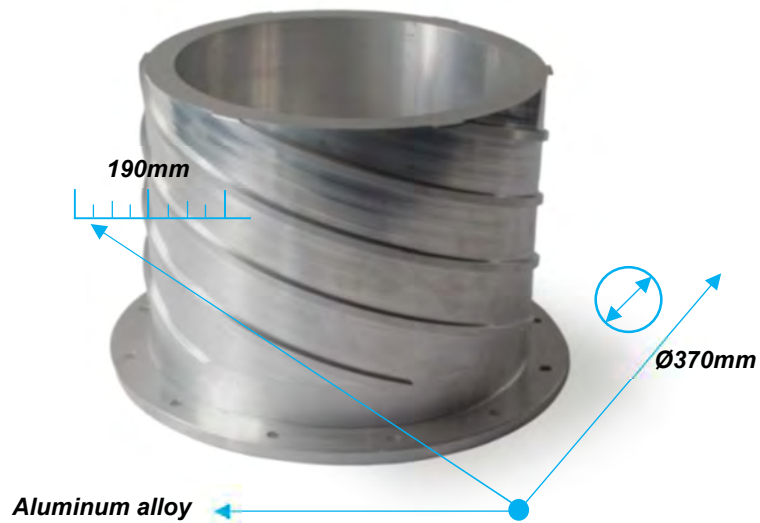



CNC Machine Center:

Machine Brand	FANUC, LIZA, Harvest, ENJOY FAME
Machine Quantities	800 Sets
Max. Machining Range	800*380*300
Spindle rotation speed	8,000~24,000rpm
Number of Axes	4, 5
Accuracy	±0.02mm

Application in:

- Medical Devices
- Datacom / Sensor
- Consumer Electronics
- Automobile
- Security
- New Energy
- Industrial

Product Type:

- Product Bodies, Components, Socket, Power Contacts, Connectors, Outer Contacts, pin, Nut, Screw, etc.
- Others specify



Die-casting Center: Multi-slider & Normal Die-casting

Multi-slider Die-casting



Die-casting

Machine Brand	ANGELCAST, YIZUMI, LIJING
Machine Quantities	29 Sets
Machine Range	25~500T
Mold size	~800X600mm
Workpiece length	~450mm
Number of Axes	~4
Accuracy	±0.05mm~

Application in:

- Medical Devices
- Datacom / Sensor
- Consumer Electronics
- Automobile
- Security
- New Energy
- Industrial

Product Type:

- Product Bodies, Components, Socket, Power Contacts, Connectors, Outer Contacts, pin, Nut, Screw, etc.
- Others specify

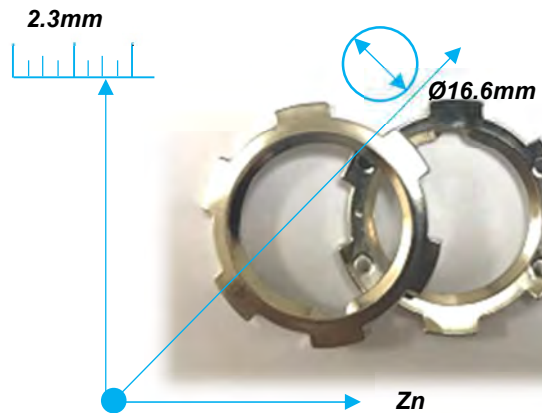

Others in House Manufacturing Process

Manufacturing Process:

Items	Equipment	Range	Qty
1	Stamping	45~220T	60
2	Forging	60~1000T	50
3	Laser Cladding & Welding		2
4	Carver	400*400*200	40
5	Mirror Effect Electric Discharge		2
6	Electric Discharge Machine (EDM)		6
7	High Speed Wire-EDM(HSWEDM)		12
8	Low Speed Wire-EDM(LSWEDM)		5
9	Automatic welding / Laser welding		3
10	Laser Etching		30
11	Ultrasonic Cleaning Line		10
12	Others		



Surface Treatment Process

In house Process:

Items	Equipment/Line	Qty
1	Electric plating	2Lines
2	Anodizing	1Line
3	Sandblasting	10Lines
4	PVD	3 Lines
5	Polishing	1 Workshop
6	Grinding	1 Workshop
7	Mirror Effect Polishing	1 Workshop
8	Chemical Etching	3 Lines
9	Nitriding	1 Line
10	Zero Discharge System	1 Workshop
11	Others...	



Inspection Equipment

Items	Brand & Equipment	Range	QTY
1	Zeiss CMM / CONTURA G2	X-1800,Y-1800,Z-1800	1
2	Zeiss CMM / CONTURA G2	X-1000,Y-1600,Z-800	1
3	Zeiss CMM / CONTURA G2	X-1000,Y-1200,Z-600	1
4	B&G CMM / GLOBAL OGP	X-400,Y-400,Z-300	1
5	Aberlink CMM / Axiom Too	X-640,Y-600,Z-850	1
6	YHD OMM / 500G	X-640,Y-600,Z-850	2
7	Mituyoto / TM-505	X-50,Y-50,Z-115	5
8	Hexagon CMM / GLOBAL SILVER	1000*1500*800	3
9	GRJO/JTVMS-2515F	2.5 Dimension	5
10	Trimos / VT 600 MA	0-610mm	5
11	Shanghai Xiguang CMM	350 ×280(200kg)	5
12	HeiHu Length	1200	5
13	Trimos Heigh / V4	Height: 900	5
14	Marsurf ps1Roughness / SJ-310	Ra0.1-Ra9.0	5
15	Hardness tester	70HRC	5
16	CCD Image	200*200*200	30
17	GAGEMAKER / MT-3000	24"	5
18	INNOVX / DS-2000-C	Alloy Metal analysis	5
19	Spectrophotometer	/	1
20	Metallurgical Microscope	/	10
21	Raw material Spectrum analyzer	/	4
23	Thermal Shock	1000*800*800	3
24	Shaking Abrasion	800*800*600	3
25	Salt Spray Test	1000*1000*800	3
26	Humidity machine	800*600*600	3
27	Others...		





LinkB Group Co., Ltd

Website: <http://www.linkbmetal.com>

China Head office:

制造基地: 广东省东莞市塘厦镇塘天南路

MP: +86 1360 9662 005
Tel: +86 769 82281069
E-mail: Info@linkbmetal.com

TAIWAN:

22175 新北市汐止區新台五路一段 97 號 28 樓之 12(A)
Zip code: 29074331 Tel: +886 2 26975005
Fax: +886 2 26975079
E-mail: Info@linkbmetal.com

U.S.A

6948, Villagewood Way, San Jose, CA 95120, U.S.
Tel +1 669 274 6349
E-mail: Info@linkbmetal.com

Japan: <http://www.linkbmetal.com/>

Furuoka Building 6F, 8-3-13 Nishigotanda, Shinagawa-ku, Tokyo 141-0031, Japan
Tel +81-3-6910-4910 FAX+81-3-6910-4930
E-mail: carliu@taihojapan.com

Representative agent for North America and Europe



François Balthazar
Mobile: 514-983-1258
1-800-479-1309 ext 707
francois.b@voltage.ca

Europe

Najib Moutaoukil
najib.m@voltage.ca

